

Thank you for purchasing your new SPELLBRITE™ LED SIGNAGE SYSTEM. Make sure to read all instructions and warnings prior to installing your new sign. Please save your purchase receipt as it is required for warranty service.

CAUTION

- Risk of electrical shock, fire or injury to persons.
- This product is intended for INDOOR USE ONLY and DRY LOCATIONS ONLY. Do not use in damp or wet locations. Do not install your product in an area that will exceed 120°F (48.9°C).
- Disconnect power before handling or cleaning.
- Do not use solvents or chemicals to clean your sign. Do not allow any liquid on or inside sign. To clean, wipe gently with soft, dry cloth.
- Use only SpellBrite-approved power sources with SpellBrite products.
- Only plug into a properly grounded outlet that meets all local and national electric codes.
- Do not use an AC extension cord or adapter.
- Operate at voltage equal to that on the product label.
- Do not use this sign with an external dimmer.
- Do not attempt to disassemble or service sign.
- Warning: Changes or modifications to this unit not expressly approved by the party responsible for compliance could void the user's authority to operate the equipment.
- Your SpellBrite sign has a variable speed flashing option. Please check your local city and state ordinances for any regulations limiting or prohibiting the use of your sign's flashing option.
- Each SpellBrite character draws a different amount of power (Amps). Please refer to our Amperage calculator at www.SpellBrite.com. SpellBrite offers multiple power supplies for different size signs.
- The SpellBrite™ Center Support Kit, part number SB-XCC-125A, is required for signs greater than 12 characters wide. Use one center support kit for signs 13-18 characters wide and an additional center support kit every additional 6 characters wide. For additional information, visit our website at www.SpellBrite.com.

NOTE: This equipment has been tested and found to comply with the limits for a Class B digital device, pursuant to Part 15 of the FCC Rules. These limits are designed to provide reasonable protection against harmful interference in a residential installation. This equipment generates, uses and can radiate radio frequency energy and, if not installed and used in accordance with the instructions, may cause harmful interference to radio communications. However, there is no guarantee that interference will not occur in a particular installation. If this equipment does cause harmful interference to radio or television reception, which can be determined by turning the equipment off and on, the user is encouraged to try to correct the interference by one or more of the following measures:

- Reorient or relocate the receiving antenna.
- Increase the separation between the equipment and receiver.
- Connect the equipment into an outlet on a circuit different from that to which the receiver is connected.
- Consult the dealer or an experienced radio/TV technician for help.

SIGN ASSEMBLY



Collect the letters that spell out the sign you want. Use end caps on left and right edges of each row.

See CAUTION notes for signs wider than 12 characters.

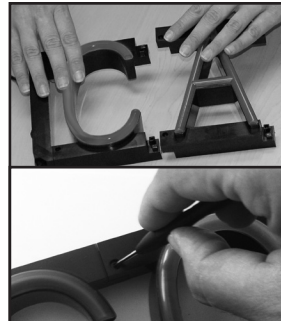

Push the letters down until an audible click. Rails should be flush. Tighten screws with screwdriver provided. Do not overtighten screws.



Connect 12V SpellBrite power supply to your sign's POWER IN jack. Turn sign on using ON/OFF switch.

See CAUTION notes for proper power supply usage.



Hang sign using hanging chains and threaded hooks provided. Optional wall-mounting hardware is available.

INSTALLATION

1. Select an indoor location to hang your SPELLBRITE sign.
2. After assembling your sign, remove the hanging chains and "S" hooks from the parts bag and attach to holes on the top of each end cap.
3. Select a surface that will fully support the sign and mount hooks securely to surface using appropriate hanging hardware.
4. If hanging in window, allow minimum 2" space between the front of the sign and the window.
5. Use only included power adapter and insert barrel plug into 12V DC power input on left end cap of sign.
6. Press ON/OFF switch to ON (I) position. Sign will illuminate.
7. To clean sign, unplug power and gently wipe surfaces with a soft, dry cloth.

CONTROL PANEL

1. Once assembled, slide ON/OFF switch on the left end cap to ON position. Your SPELLBRITE sign will illuminate.
2. To change the brightness of your sign, press the BRIGHTNESS button (button #1). There are six BRIGHTNESS choices.
3. To change the animation, press the ANIMATION button (button #2). There are eight shows including a static show.
4. Depressing both ANIMATION and BRIGHTNESS buttons at the same time will set the control board back to the default setting. Default setting is Show #3 (Medium Pulse) and 100% brightness.

LEFT END CAP & CONTROLS

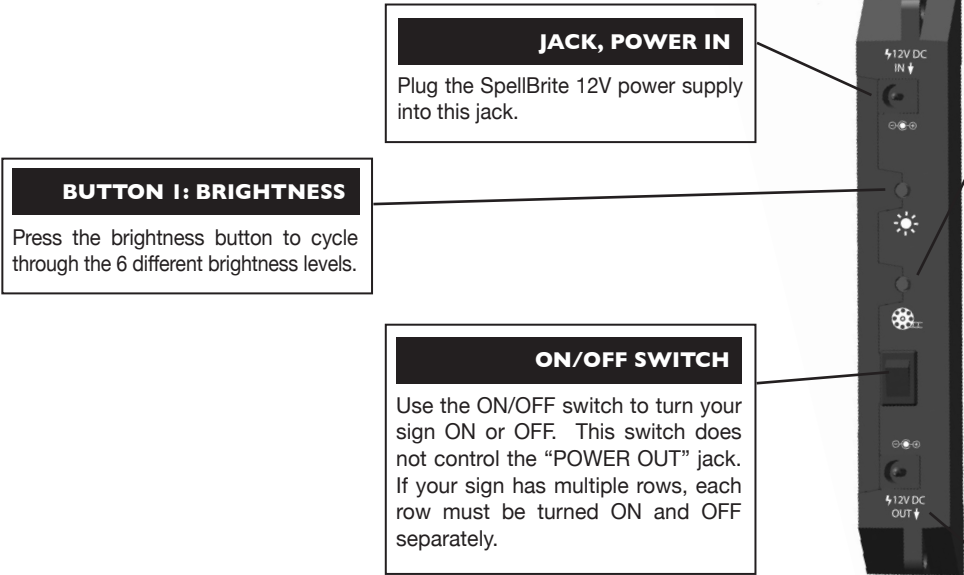

JACK, POWER IN
Plug the SpellBrite 12V power supply into this jack.

BUTTON 1: BRIGHTNESS
Press the brightness button to cycle through the 6 different brightness levels.

ON/OFF SWITCH
Use the ON/OFF switch to turn your sign ON or OFF. This switch does not control the "POWER OUT" jack. If your sign has multiple rows, each row must be turned ON and OFF separately.

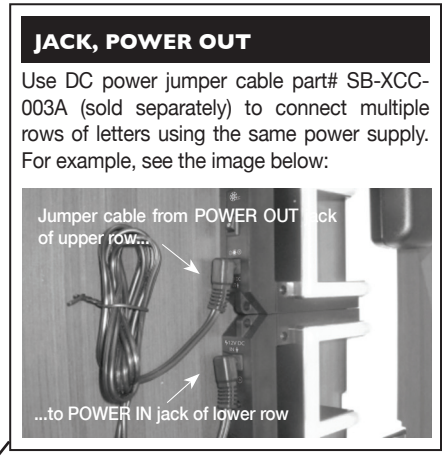
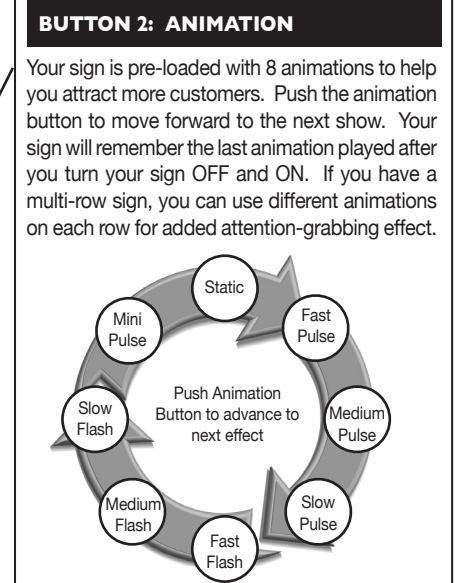

For additional operating instructions, please visit to www.SpellBrite.com.

WARRANTY REGISTRATION SPELLBRITE™ LED SIGNAGE SYSTEM

Register online at warranty.SpellBrite.com

SPELLBRITE™ SIGNS LIMITED PRODUCT WARRANTY

All SpellBrite™ products manufactured by iLight Technologies, Inc. ("Manufacturer") are warranted to be free from defects in material and workmanship under intended use and service (normal wear and tear excepted), and subject to the terms and conditions set forth below for one (1) year from the invoice date of the purchase.

Terms and Conditions

The Limited Product Warranty applies only when the Product is used in accordance with printed instructions. The Limited Product Warranty does not apply to any abnormal use or failure to comply with federal, state or local laws. Replacement of Manufacturer's components with components of other manufacturers will void the Limited Product Warranty. The Limited Product Warranty does not cover misuse or abuse, acts of God or accidents, environmental conditions, defects resulting from improper installation, lack of proper maintenance, unauthorized repair, alteration or disassembly by unauthorized personnel, or operation by improper voltage or current (including power surges).

Repair or Replacement of Defective Product

Claim must be made directly to iLight Technologies, Inc., at 312-568-5760, prior to return of Product. Returns must be made within 30 days of submitting a claim and must include the Product and original receipt, along with the Manufacturer's provided return material authorization number (RMA). Manufacturer must be given a reasonable opportunity to inspect and verify the claim, and shall correct such defect by repair or replacement, F.O.B. factory, of the defective part or parts.

Manufacturer's obligation under this Limited Product Warranty shall be limited to replacing or repairing, at its sole option, the Product or the defective part thereof which shall, within the applicable Warranty Period set forth above, be determined to be defective, and has not been damaged due to improper use, within Manufacturer's sole discretion. The Limited Product Warranty flows only to Purchaser and does not include shipping costs or expenses. If Manufacturer chooses to replace the Product and is not able to do so because it has been discontinued or is not available, Manufacturer may replace it with a comparable product.

These express limited warranties state the entire liability of Manufacturer with respect to the Products covered by them.

Limits of Liability

Manufacturer's liability arising from, or in any way connected with, the Products sold, the delivery or any delay with respect thereto, or otherwise arising from, or relating to the Limited Product Warranty, shall be limited solely and exclusively, and at Manufacturer's sole election, to either repair or replacement of Products sold.

In no event shall Manufacturer be liable for any incidental, consequential, or special damages of any kind or nature whatsoever, including, but not limited to, lost profits or revenues arising from or in any way connected with the Limited Product Warranty, or items sold hereunder, whether alleged to arise from breach of contract, express or implied warranty, or in tort, including, without limitation, negligence, failure to warn or strict liability.

NO PERSON IS AUTHORIZED TO MAKE ANY REPRESENTATION OR WARRANTY ON BEHALF OF MANUFACTURER EXCEPT AS EXPRESSLY SET FORTH ABOVE, AND ANY SUCH STATEMENT SHALL NOT BE BINDING ON MANUFACTURER, EXCEPT AS EXPRESSLY SET FORTH ABOVE. MANUFACTURER MAKES NO WARRANTY OF ANY KIND, EXPRESS OR IMPLIED, INCLUDING, WITHOUT LIMITATION, ANY IMPLIED WARRANTY OF MERCHANTABILITY OR FITNESS FOR A PARTICULAR PURPOSE.

All questions concerning the meaning or applicability of this limited warranty are to be decided under the laws of the State of Illinois without reference to its choice of law rules. Any claims, demands or causes of action for defects or representations of any nature or damages arising from such defects or representations shall be subject to the exclusive jurisdiction of the state and/or federal courts located in Chicago, Illinois.

iLight Technologies, Inc. • SpellBrite Signs • 118 S. Clinton St., Suite 370 • Chicago, IL • 60661 • T 312.568.5760 • www.SpellBrite.com

INSTRUCTIONS

Please register online at warranty.SpellBrite.com or fill out the information requested, cut at line and mail in envelope to:

iLight Technologies, Inc.
SpellBrite Signs
118 S. Clinton St.,
Suite 370
Chicago, IL 60661 USA



WARRANTY REGISTRATION

Register online at warranty.SpellBrite.com

NAME _____

COMPANY _____

STREET ADDRESS _____

CITY _____ ST./PROVINCE _____ ZIP _____

TELEPHONE _____

BATCH NO. (Found on end cap label) _____

DATE OF PURCHASE ____ / ____ / ____ PURCHASED FROM _____

E-MAIL _____

1. Is this replacing a neon sign? Yes No
2. What is your business type?
 - Food/Drink
 - Convenience Store
 - Clothing
 - Tax / Insurance
 - Beauty
 - Dry Cleaners
 - Automotive
 - Residential
 - Other _____
3. Rank each of these on order of importance:

	Hi	Med	Lo
Overall Look	<input type="radio"/>	<input type="radio"/>	<input type="radio"/>
Price	<input type="radio"/>	<input type="radio"/>	<input type="radio"/>
Brightness	<input type="radio"/>	<input type="radio"/>	<input type="radio"/>
Energy Savings	<input type="radio"/>	<input type="radio"/>	<input type="radio"/>
Fits Anywhere	<input type="radio"/>	<input type="radio"/>	<input type="radio"/>
Reuseable	<input type="radio"/>	<input type="radio"/>	<input type="radio"/>
See-Through	<input type="radio"/>	<input type="radio"/>	<input type="radio"/>
4. Where did you learn about SPELLBRITE signs?
 - Store Display
 - Salesperson
 - Internet
 - Friend
 - Store Ad
 - Other _____
5. What other enhancements or new products would you like to see? _____